

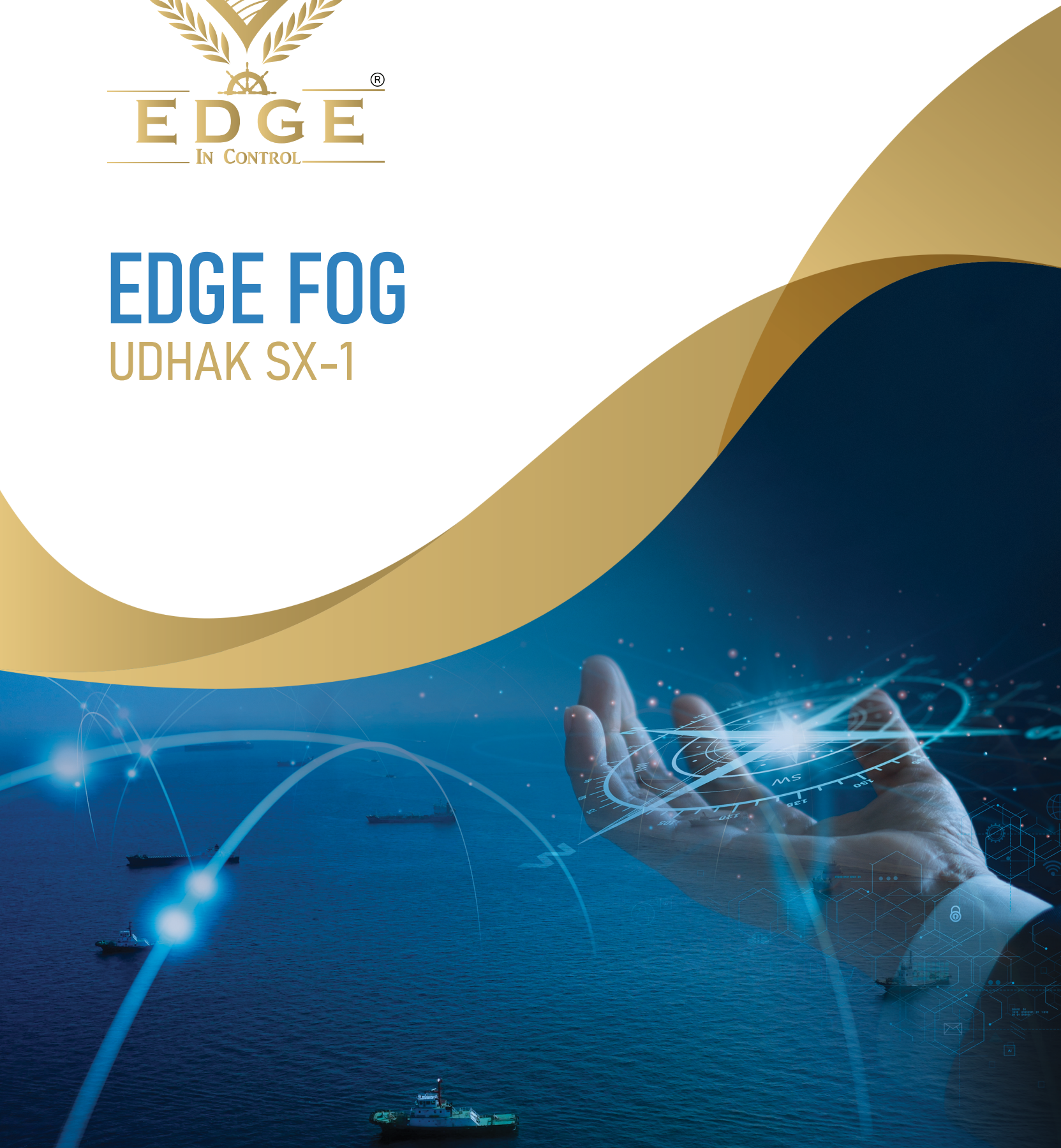

Maritronics®
Marine Electronic Engineers

EDGE FOG

UDHAK SX-1





PRODUCT OVERVIEW

EDGE FOG-UDHAK SX1 is highly accurate, maintenance free, type approved Marine Fiber optic gyro (FOG) compass developed for all types of surface based high speed and low speed marine vessels.

EDGE FOG employs an inertial navigation system offering true heading, roll and pitch.

It quickly settles on its full heading accuracy of $\pm 0.5^\circ$ secant latitude RMS- within ~10 minutes. It provides higher stability and good linearity with latitude and longitude compensation.

The output data can be monitored on a dedicated 8" touch display unit with heading difference alarm and self-test functionality.

The fully sealed rugged sensor is designed to meet and exceed military standards that test for shock, vibrations, wide temperature operation, sand, dust, salt, fog and Electromagnetic Interface and compliance to EMI/EMC.



FEATURES AND BENEFITS

- IMO approved fiber optic gyroscope*
- Inertial Navigation System
- Dead reckoning
- All-in-one high accuracy with heading, roll and pitch
- Inbuilt compass comparator
- 8" Capacitive touch screen display for data monitoring and controls
- Maintenance free
- Static and dynamic alignment modes with and without GPS
- Multiple protocols & interfaces
- Easier replacement for traditional gyrocompass
- Maximum reliability and sustained performance
- Wide variety of repeaters available in the offering
- Quickfit cable harness for easy installation and troubleshooting

* IMO certification under process



EDGE[®]
IN CONTROL

EDGE FOG
UDHAK SX-1

SYSTEM ARCHITECTURE

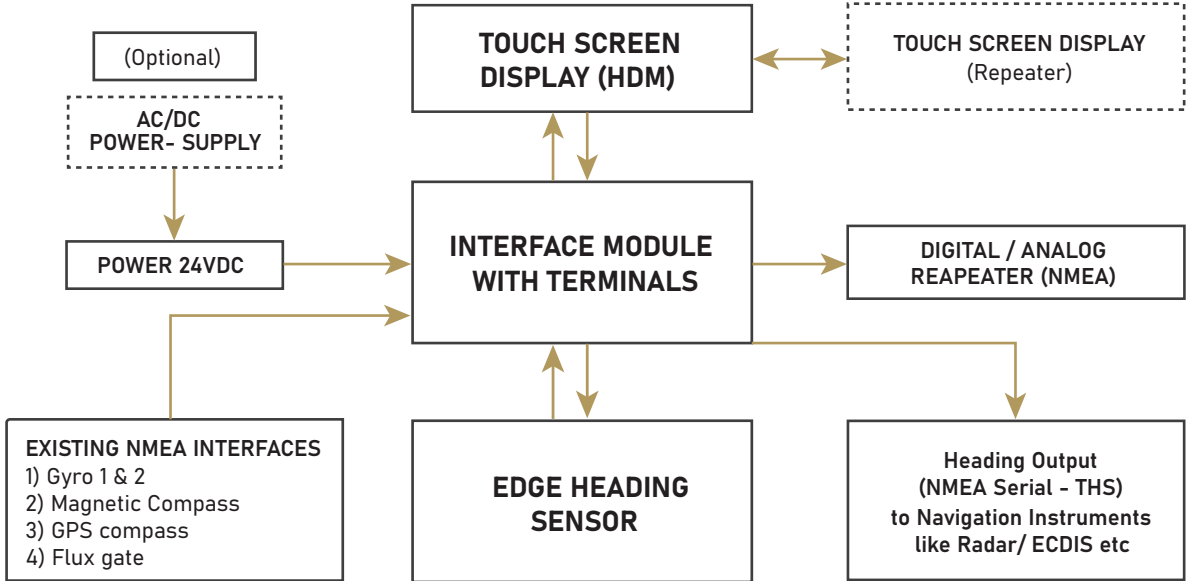

THE TYPE APPROVED EDGE FOG SYSTEM COMPRISES OF THE FOLLOWING COMPONENTS

COMPONENT	PART NUMBER
FOG Sensor unit	EU-SFU
8" Capacitive touch HMI	EU-WHDM
Power supply with auto changeover	EU-PSU
EDGE NMEA buffer unit	EN2A8-R1





TECHNICAL SPECIFICATION

PERFORMANCE	
Heading accuracy	≤0.5 deg secant latitude
Roll and pitch	0.1 deg
Settling time	<10 min

COMMUNICATION	
Serial	NMEA0183(IEC-61162-1)
Baud rate	4800-115200(Configurable)
No.of.ports	4
Alarm output	Dry contact, NMEA

OPERATING RANGE/ ENVIRONMENT:	
Operating voltage	110-230VAC / 24V DC
Operating/Storage temperature	-40 °C to +65 °C / -45 °C to +70°C
Power consumption	20W
EMI/EMC	Meets IEC-60945 Standards
Output	RS-422
Environmental protection	IP65 (sensor)
MTBF	≥ 20,000 hrs



EDGE
IN CONTROL

EDGE FOG
UDHAK SX-1

PHYSICAL CHARACTERISTICS	
Dimensions (Sensor)	145x122x125(LxWxH)mm
Dimensions (Display)	229x157x66(LxWxH)mm
Weight (Sensor)	5kg
Weight (Display)	3kg
REGULATION AND STANDARDS	
IEC 60945	
IEC 61162	
IEC 62288*	
IEC 62923*	
ISO 8728*	
ISO 16328*	

*certifications under process

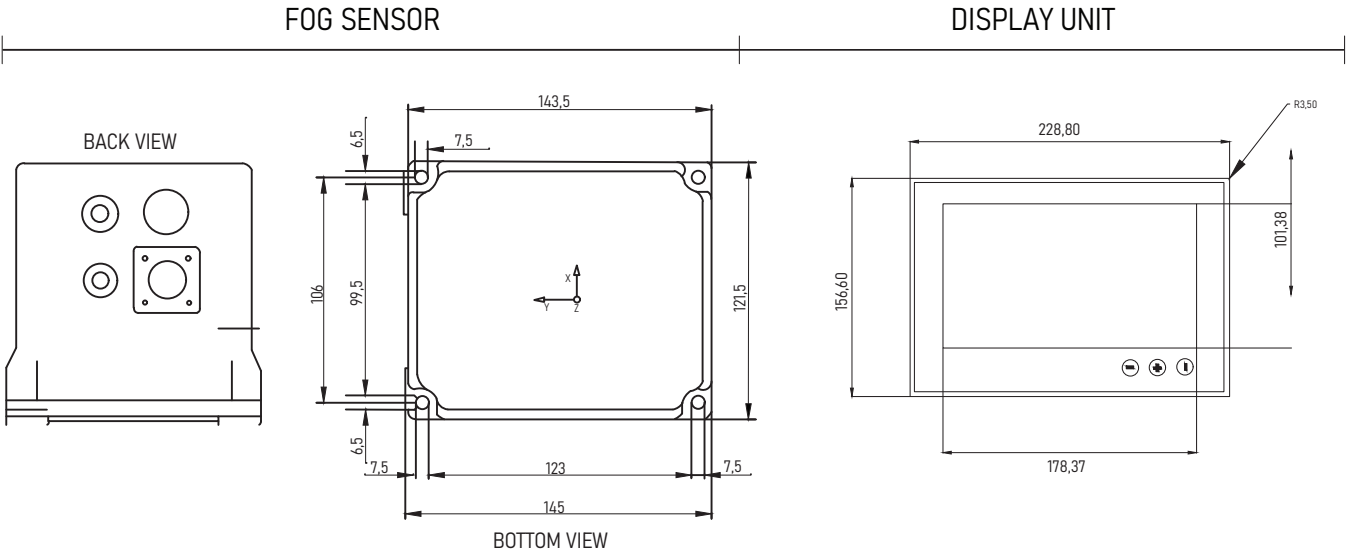

FOLLOW US
ON OUR SOCIAL NETWORKS
   
@maritronicsindia

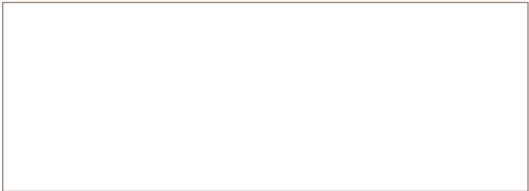

Maritronics India PVT LTD,
No.1, KRM Towers, 8th Floor, Harrington Road,
Chetpet, Chennai – 600031, Tamil Nadu, India.
www.maritronics.com

