

Solar Power Supply Solutions

10-180 watt models

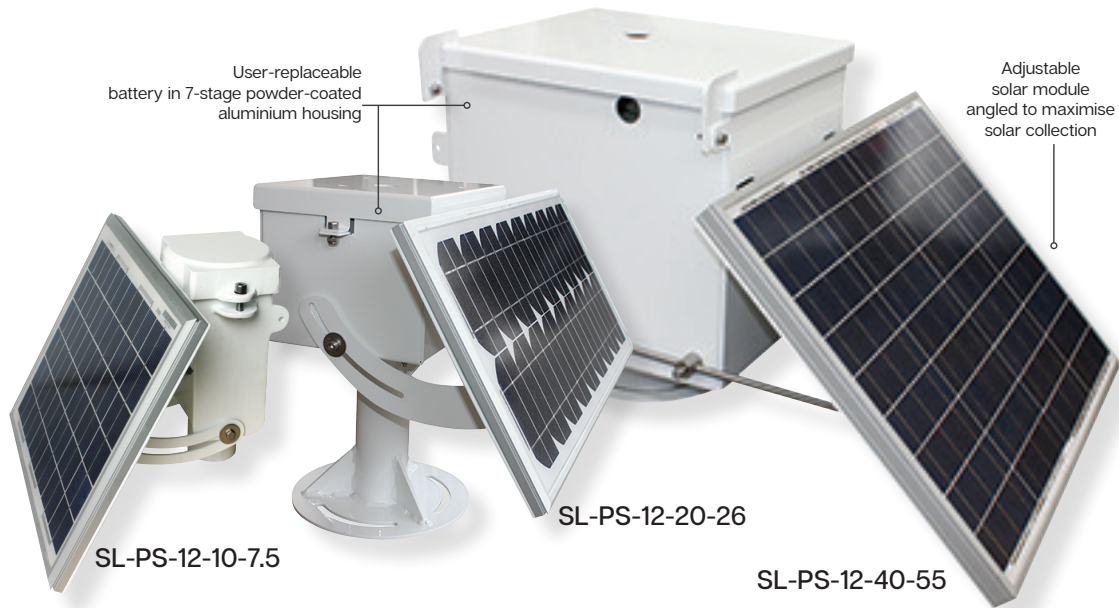

Sealite offers a range solar power supplies to suit stand-alone navigation aid installations, such as marine lanterns and precision sector lights.

The solar power supplies are available in multiple configurations, including various battery and solar sizing, and self-contained or modular options. In addition, Sealite can provide customised designs for unique installation requirements.

Solar Power Supplies

Electrical Characteristics & Specifications*

Model	SL-PS-12-10-7.5	SL-PS-12-20-26	SL-PS-12-40-26	SL-PS-12-40-55
Solar Panel (W)	10W	20W	40W	40W
Battery Size (Ah)	7.5Ah	26Ah	26Ah	55Ah

Model	SL-PS-12-60-55	SL-PS-12-90-110	SL-PS-12-140-110	SL-PS-12-180-110
Solar Panel (W)	60W	90W	140W	180W (2x 90W)
Battery Size (Ah)	55Ah	110Ah	110Ah	110Ah

Model	SL-PS-12-270-110	SL-PS-12-90-220	SL-PS-12-140-220	SL-PS-12-180-220
Solar Panel (W)	270W (3x 90W)	90W	140W	180W (2x 90W)
Battery Size (Ah)	110Ah	220Ah	220Ah	220Ah

Model	SL-PS-12-180-440	SL-PS-12-270-220	SL-PS-12-280-330	SL-PS-12-560-330
Solar Panel (W)	180W (2x 90W)	270W (3x 90W)	280W (2x 140W)	560W (4x 140W)
Battery Size (Ah)	440Ah	220Ah	330Ah	330Ah

* Specifications subject to change or variation without notice
 * Subject to standard terms and conditions

The Sealite Advantage

- Power supplies available in multiple configurations & sizes to suit various applications
- Solar panel tilt angle can be set to suit geographical location
- Custom designs available for larger systems or specific installation requirements
- Easy to install and service

Technical Illustrations

SL-PS-12-10-7.5

10 watt power supply, includes;

- 1 x 10 watt solar panel
- 1 x 7.5Ah battery
- Delivers 0.58 Amp/hour
- Solar charge controller
- Weatherproof battery housing
- 16mm cable gland in mounting spigot
- Additional 16mm tapped hole with blanking plug

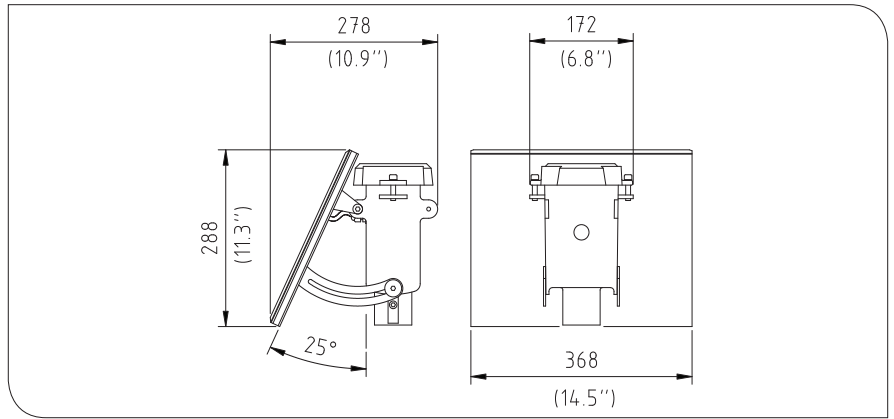

SL-PS-12-20-26

20 watt power supply, includes;

- 1 x 20 watt solar panel
- 1 x 26Ah battery
- Delivers 1.16 Amp/hour
- Solar charge controller
- Weatherproof battery housing
- 16mm cable gland cable access

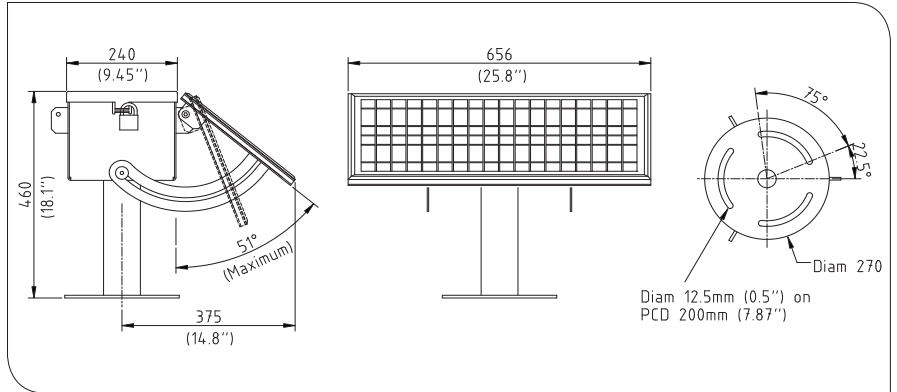

SL-PS-12-40-26

40 watt power supply, includes;

- 1 x 40 watt solar panel
- 1 x 26Ah battery
- Delivers 2.32 Amp/hour
- Solar charge controller
- Weatherproof battery housing
- 16mm cable gland cable access

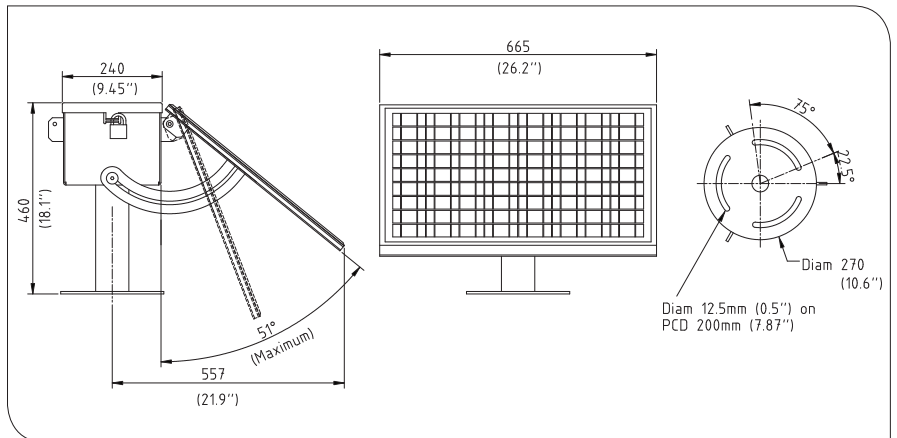

SL-PS-12-40-55

40 watt power supply, includes;

- 1 x 40 watt solar panel
- 1 x 55Ah battery
- Delivers 2.32 Amp/hour
- Solar charge controller
- Weatherproof battery housing
- Lockable powder coated battery box c/w 200mm bolt pattern mount - Type 2 series
- 16mm cable gland access

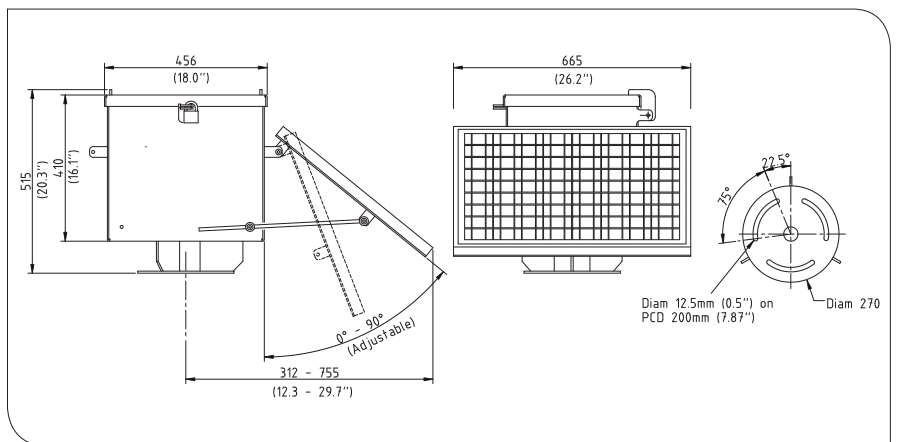

† Intensity setting subject to solar availability

* Subject to standard terms and conditions

• Specifications subject to change or variation without notice
 ^ Refer to the Sealite website under the warranty section



We believe technology improves navigation™

Technical Illustrations

SL-PS-12-65-55

65 watt power supply, includes;

- 1 x 65 watt solar panel
- 1 x 55Ah battery
- Delivers 3.44 Amp/hour
- Solar charge controller
- Weatherproof battery housing
- Lockable powder coated battery box c/w 200mm bolt pattern mount - Type 2 series

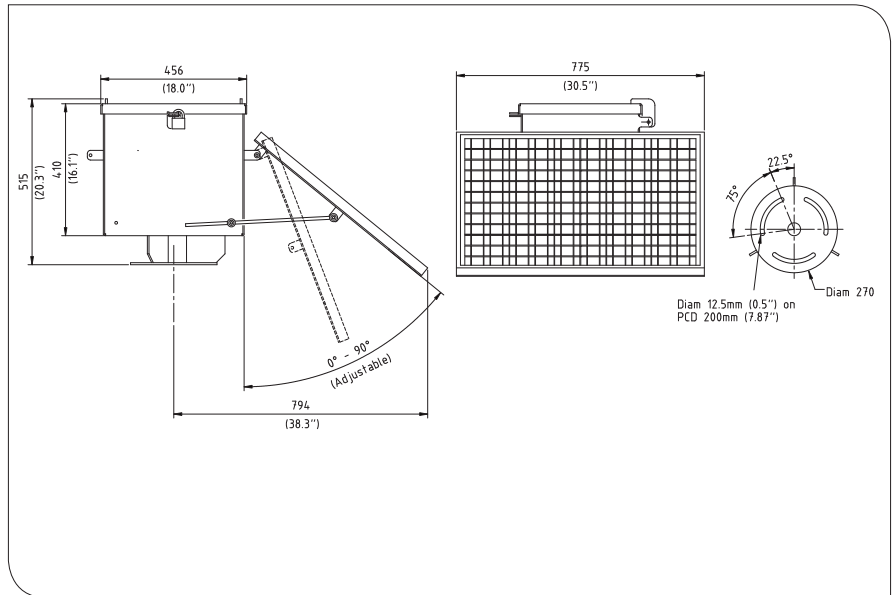

SL-PS-12-90-110

90 watt power supply, includes;

- 1 x 90 watt solar panel c/w wall mounting bracket
- 1 x 110Ah batteries
- Delivers 5.17 Amp/hour
- Solar charge controller
- Weatherproof battery housing
- Lockable powder coated battery box c/w 200mm bolt pattern mount - Type 2 series
- 3mtr cabling to solar module & fixtures

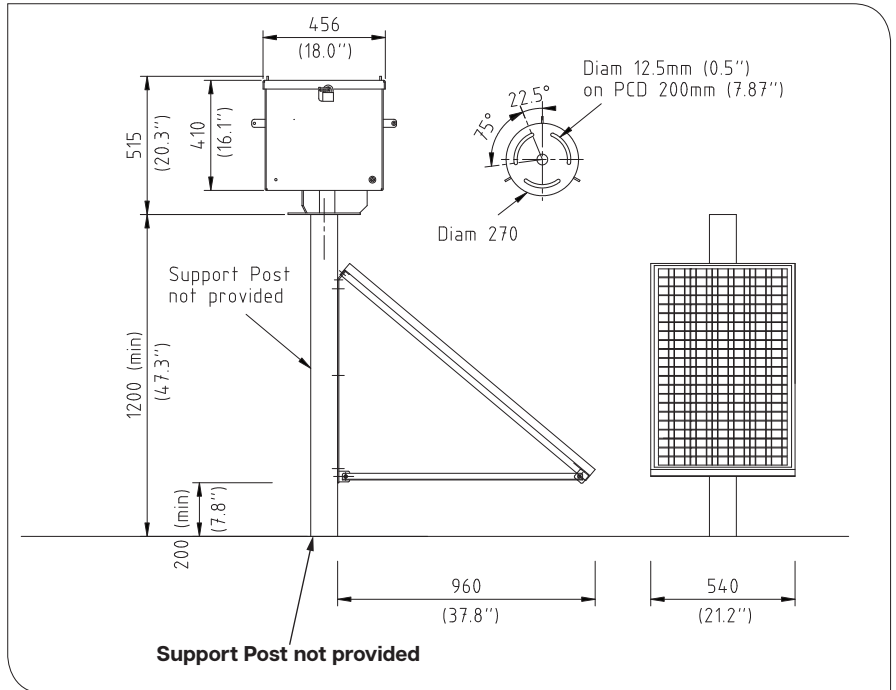

† Intensity setting subject to solar availability

* Subject to standard terms and conditions

• Specifications subject to change or variation without notice
 ^ Refer to the Sealite website under the warranty section



We believe technology improves navigation™

Technical Illustrations

SL-PS-12-140-110

140 watt power supply, includes;

- 1 x 140 watt solar panel c/w wall mounting bracket
- 1 x 110Ah battery
- Delivers 8.14 Amp/hour
- Solar charge controller
- Weatherproof battery housing
- Lockable powder coated battery box c/w 200mm bolt pattern mount - Type 2 series
- 3mtr cabling to solar module & fixtures

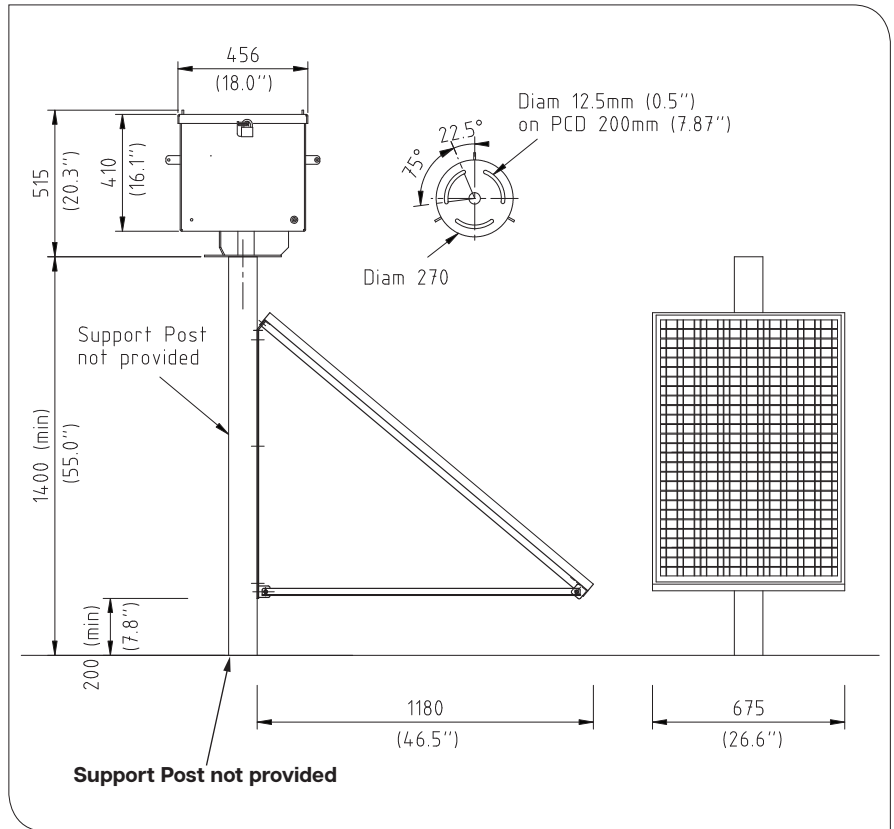

SL-PS-12-180-220

180 watt power supply, includes;

- 2 x 90 watt solar panel c/w wall mounting bracket
- 2 x 110Ah batteries
- Delivers 10.34 Amp/hour
- Solar charge controller
- Weatherproof battery housing
- Lockable powder coated battery cage (wall mounting)
- 3mtr cable to solar module & fixtures

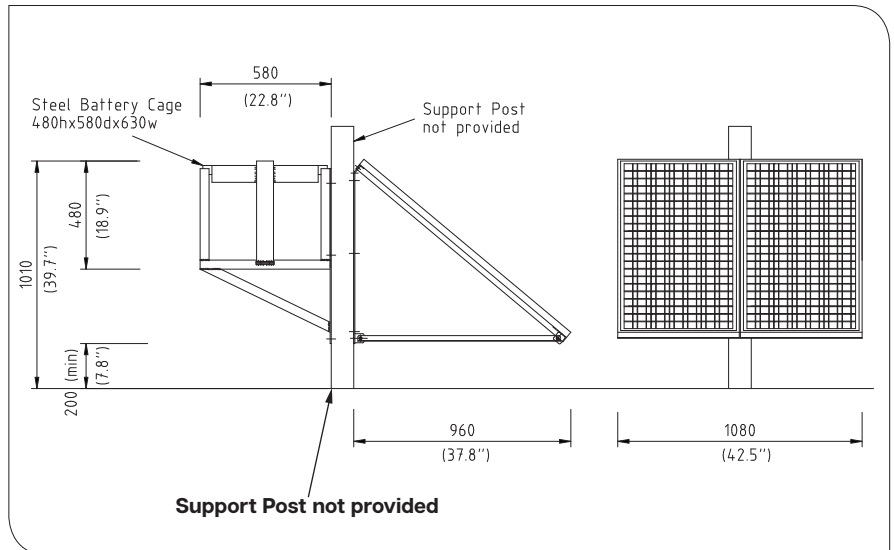

† Intensity setting subject to solar availability

* Subject to standard terms and conditions

• Specifications subject to change or variation without notice
 ^ Refer to the Sealite website under the warranty section



We believe technology improves navigation™

Bridge Light

SL-BR Series

Optional



GPS Sync



GSM Monitoring

This equipment complies with requirements of the U.S. Coast Guard in 33 CFR part 118



The SL-BR Series are an LED Bridge Light. They are specifically designed to clearly mark bridges and structures extending over navigable waterways. Used extensively throughout the USA, the SL-BR Series has been designed to offer superior visibility up to 4NM, and operate in conjunction with existing power supplies.

The light is available as a 180° sectored red model or 360° green model and comes fixed-on as standard. The fixtures are also available with a range of factory-set flash characteristics and sectoring requirements to suit local regulations.

The light is available in two configurations, nominal 12VDC or universal AC (110-240VAC).

The SL-BR series can also be supplied as a complete solar/battery system to comply with requirements of regional governing bodies such as the U.S. Coast Guard, or the IALA Recommendations for the marking of fixed bridges over navigable waters.

Sealite has a range of other short, medium and long range marine lanterns that may also be used to comply with bridge lighting requirements.



SL-155 180° model for bridge fenders & abutments

SL-155 Series bridge lights



Sectored Bridge Light



Optional solar/battery systems and optional mounting accessories are available

Advantage

- Up to 4NM visible range
- Able to operate in conjunction with existing power supplies

Optional Add Ons

- Solar/battery systems available
- Universal AC: will accept between 110-240VAC
- Mounting accessories

Technical Specifications **

	SL-BR Series (2NM)	SL-BR4 Series (4NM)
Light Characteristics		
Light Source	LED	
Available Colours	Red, Green, other colours available on request	
Visible Range (NM)	AT @ 0.74: 2 (nominal)	AT @ 0.74: 4 (nominal)
	AT @ 0.85: 2.3	AT @ 0.85: 4.6
Horizontal Output (degrees)	360 or 180	
Vertical Divergence (degrees)	9	
Available Flash Characteristics	Steady-on (standard). Other factory set flash patterns available on request	
LED Life Expectancy (hours)	>100,000	
Electrical Characteristics		
Current Draw (mA)	VDC Model: 40 @ 12 VDC	VDC Model: 80 @ 12 VDC
Circuit Protection	Integrated	
Nominal Voltage (V)	VDC Model: 12 VDC VAC Model: 110–240 VAC	
Temperature Range	-40 to 80°C	
Physical Characteristics		
Body Material	LEXAN® Polycarbonate – UV stabilised	
Lens Material	LEXAN® Polycarbonate – UV stabilised	
Lens Diameter (mm/inches)	107 / 4 1/4	
Lens Design	LED optic	
Mounting	50mm OD pole	
Height (mm/inches)	105 / 4	
Width (mm/inches)	109 / 4 1/4	
Mass (kg/lbs)	1.2 / 2 1/2	
Product Life Expectancy	Up to 12 years ^	
Certifications		
CE	EN61000-6-3:2007 EN61000-6-1:2007	
IALA	Signal colours compliant to IALA E-200-1	
USCG	33 CFR Part 118	
Quality Assurance	ISO 9001:2015	
Waterproof	IP68	
Intellectual Property		
Patents	US Pat. No. 6,667,582. AU Pat. No. 778,918	
Trademarks	SEALITE® is a registered trademark of Sealite Pty Ltd	
Warranty *	3 years	
Options Available	<ul style="list-style-type: none"> • Mounting assemblies • Solar/battery systems <ul style="list-style-type: none"> • Light sectoring • Additional cable • GPS Synchronisation (DC Model) • GSM Monitoring and Control System (DC Model) 	

CE • Specifications subject to change or variation without notice * Subject to standard terms and conditions
^ Refer to the Sealite website under the warranty section

Power Current in Electrical Circuit (VA)

Bridge Light Colour	VA
White	6.2
Green	6.9
Red	7.8

Technical Illustration

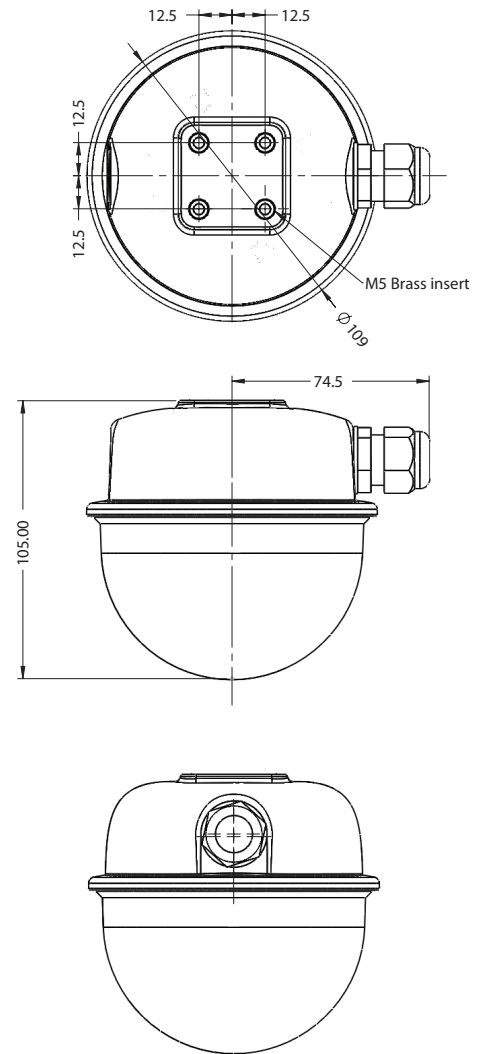

We believe technology improves navigation™

Bridge Light

SL-BR Series



Sectored Bridge Light

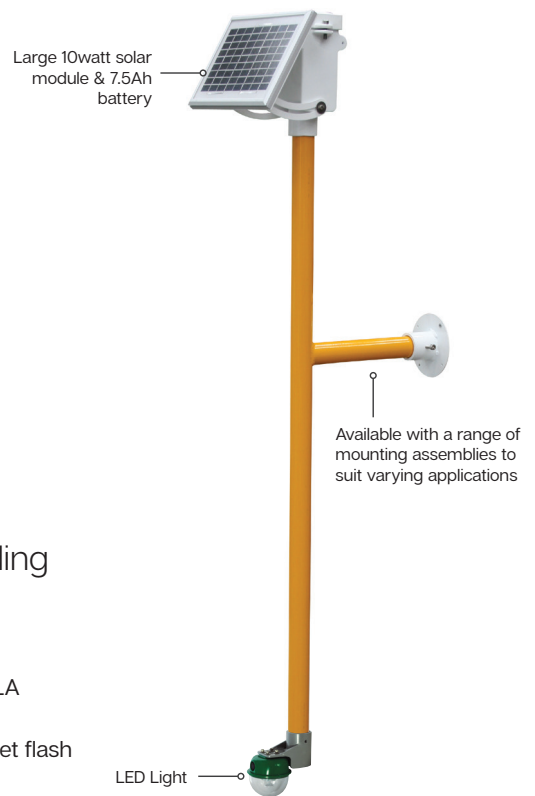

Sealite's SL-BRK is solar Bridge Lighting Kit specifically designed to clearly mark bridges and structures extending over navigable waterways, and is used extensively throughout the USA.

The SL-BRK features a large solar power supply (10watt solar module with 7.5Ah SLA battery), positioned at the top of the assembly to maximise solar collection.

The lantern is steady-on as standard but is available with a range of other factory-set flash characteristics and sectoring requirements to suit local regulations.

The optional long extension arm between the light and the power supply ensures clear visibility of the AtoN from mariners below.

PLEASE NOTE: the extension arm is not included with the standard SL-BRK bridge lighting kit.

Sealite has a range of other marine lanterns that may also be used to comply with bridge lighting requirements.

Bridge lights are typically steady-on, however a choice of over 256 IALA recommended flash patterns are available as standard.

The lights are configured as complete solar/battery systems to comply with requirements of regional governing bodies such as the U.S. Coast Guard, or the IALA Recommendations for the marking of fixed bridges over navigable waters.

In U.S. waters for instance, the Coast Guard prescribes certain combinations of fixed lights for bridges and structures extending over waterways. In general, red lights are used to mark piers and supports, and green lights mark the centreline of the navigable channel through a fixed bridge.

If there is more than one channel through the bridge, the preferred route is marked by three white lights placed vertically. Red lights are also used on some lift bridges to indicate the lift is closed, and green lights to indicate that the lift is open to vessel traffic.

Double-opening, swing bridges are lighted with three lanterns on top of the span structure so that when viewed from an approaching vessel the swing span when closed will display three red lights, and when open for navigation will display two green lights.

Typical Night Marking of Bridge Structures Generally Include:

- Red or green lights to mark the navigable limits of the channel in accordance with the IALA Maritime Buoyage System located on the bridge piers, under the span, or on buoy and beacons in the water
- A 'best point of passage' indicated by a white light(s) located under the span and exhibiting a safe water mark character

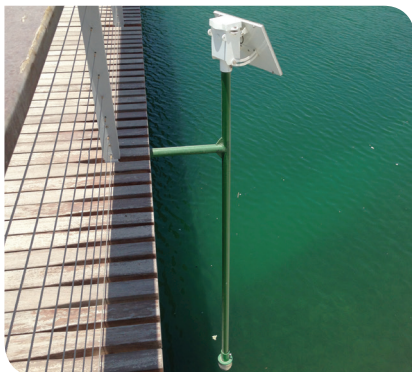

Contact your local authority for a full description of bridge marking requirements for your region.

For a copy of the IALA Recommendations for the marking of fixed bridges over navigable waters please contact Sealite.