

## **Anchors, Anchor Chains & Accessories**

Aeromarine Anchors, Anchor Chains and Accessories houses a wide range of brand new & second-hand shipping chains and offshore chains located in Panvel, Mumbai and Vizag in our own-warehouse.

**We offer 24 hours a day, and 365 days a year across India.**

# STUD LINK ANCHOR CHAIN

## Anchor Chain and Accessories Specification

No. of links per 27.5 m. (90 ft.)	Chain Diameter	Grade2		Grade3		Approx.mass (27.5mm)	No. of links per 27.5 m. (90 ft.)	Chain Diameter	Grade2		Grade3		Approx.mass (27.5mm)
		Proof load	Breaking load	Proof load	Breaking load				Proof load	Breaking load	Proof load	Breaking load	
		C=0.0098	C=0.0137	C=0.0137	C=0.0196				C=0.0098	C=0.0137	C=0.0137	C=0.0196	
mm	KN	KN	KN	KN	kg	mm	KN	KN	KN	KN	kg		
491	14	82	116	116	165	130	107	64	1560	2190	2190	3130	2529
429	16	107	150	150	216	170	105	66	1660	2310	2310	3300	2689
391	17.5	127	179	179	256	189	99	68	1750	2450	2450	3500	2858
357	19	150	211	211	301	226	97	70	1840	2580	2580	3690	3025
329	20.5	175	244	244	349	263	93	73	1990	2790	2790	3990	3341
305	22	200	280	280	401	303	89	76	2150	3010	3010	4300	3566
285	24	237	332	332	476	370	87	78	2260	3160	3160	4500	3756
259	26	278	389	389	556	439	85	81	2410	3380	3380	4820	4050
245	28	321	449	449	642	496	81	84	2580	3610	3610	5160	4355
225	30	368	514	514	735	564	79	87	2750	3850	3850	5500	4672
213	32	417	583	583	833	635	77	90	2920	4090	4090	5840	5000
195	34	468	655	655	937	724	73	92	3040	4260	4260	6080	5224
187	36	523	732	732	1050	812	71	95	3230	4510	4510	6440	5571
179	38	581	812	812	1160	905	71	97	3340	4680	4680	6690	5809
171	40	640	896	896	1280	1032	69	100	3530	4940	4940	7060	6174
165	42	703	981	981	1400	1075	67	102	3660	5120	5120	7320	6423
153	44	769	1080	1080	1540	1197	65	105	3850	5390	5390	7700	6806
147	46	837	1170	1170	1680	1310	63	107	3980	5570	5570	7960	7067
143	48	908	1270	1270	1810	1438	61	111	4250	5940	5940	8480	7606
137	50	981	1370	1370	1960	1536	59	114	4440	6230	6230	8890	8023
129	52	1060	1480	1480	2110	1669	57	117	4650	6510	6510	9300	8450
125	54	1140	1590	1590	2270	1780	57	120	4850	6810	6810	9720	8889
123	56	1220	1710	1710	2430	1936	57	122	5000	7000	7000	9990	9187
119	58	1290	1810	1810	2600	2086	55	124	5140	7200	7200	10280	9492
113	60	1380	1940	1940	2770	2249	55	127	5350	7490	7490	10710	9957
111	62	1470	2060	2060	2940	2373							

Note: Test load = C x D<sup>2</sup> (44-0.08d)

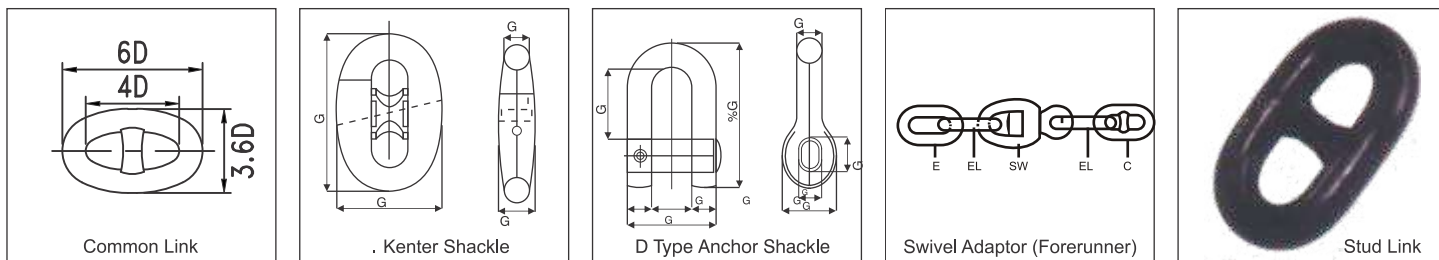

# ANCHOR CHAIN ACCESSORIES STUD LINK CHAIN CABLE & FITTINGS

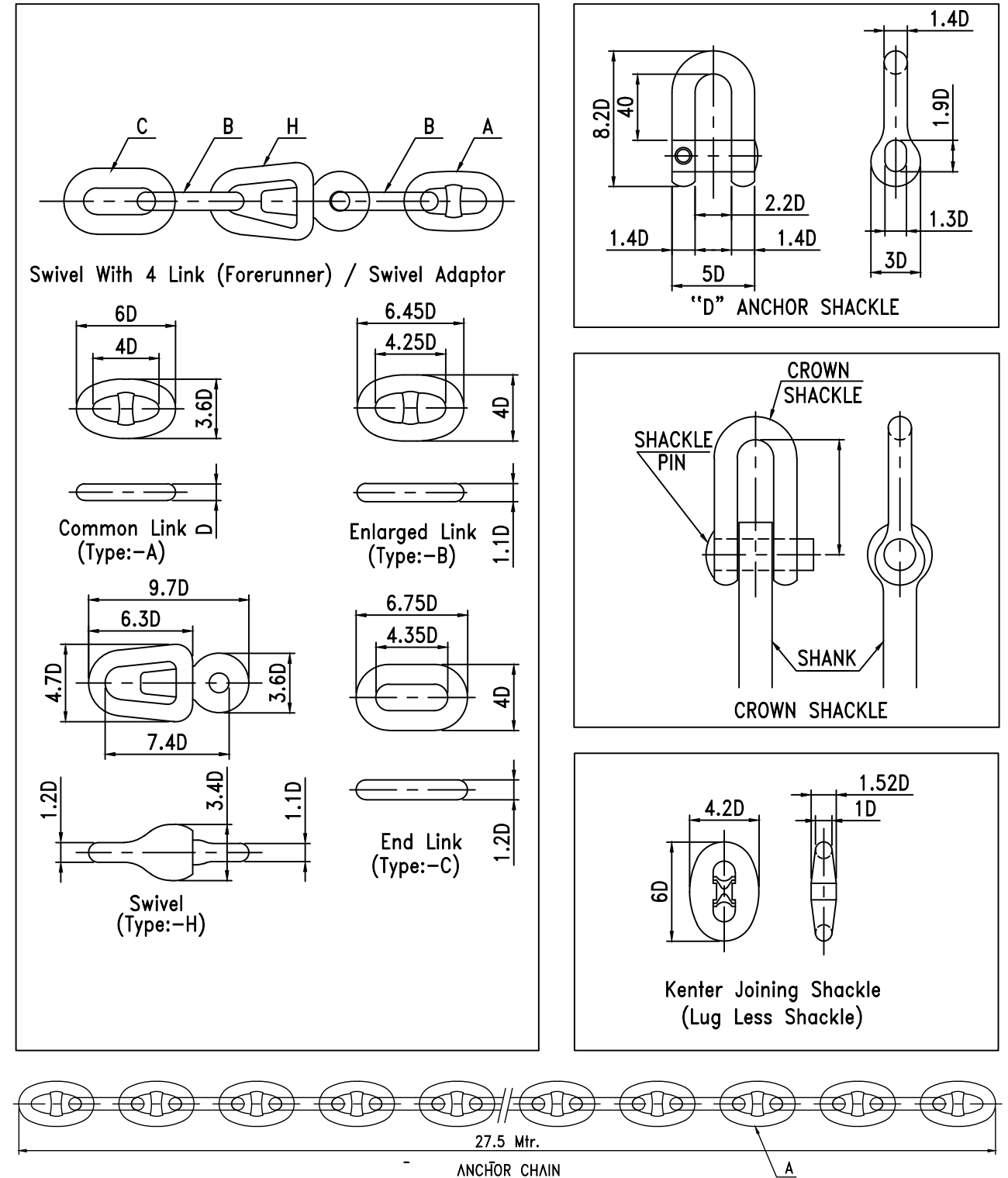

# STOCKLESS ANCHOR

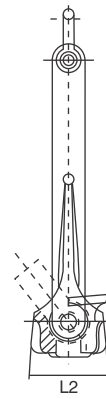
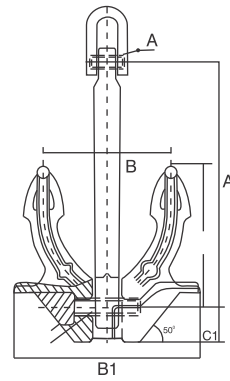

DIMENSION OF STOCKLESS ANCHOR					
NORMAL WEIGHT(kg)	B1	C	B	L2	A
50	400	270	284	172	450
75	480	318	339	200	550
100	540	358	381	232	760
120	570	420	402	245	800
140	600	443	424	258	840
165	630	456	445	271	880
180	650	480	459	280	910
200	660	487	466	284	920
240	720	530	510	310	1010
300	770	570	540	331	1080
360	820	610	560	353	1150
420	860	640	610	370	1200
480	900	670	640	387	1260
570	950	700	670	408	1330
660	1000	740	710	430	1440
780	1060	780	750	456	1480
900	1110	820	780	470	1550
1020	1160	860	820	500	1620
1140	1200	890	850	520	1680
1290	1250	920	880	540	1750
1440	1300	960	920	560	1820
1590	1340	990	950	580	1880
1740	1380	1020	980	600	1930
1920	1430	1060	1010	620	2000
2100	1470	1090	1040	640	2060
2280	1510	1120	1070	650	2100
2460	1550	1150	1100	670	2170
2640	1590	1180	1120	690	2230
2850	1630	1210	1150	700	2230
3060	1670	1240	1180	720	2340
3300	1710	1270	1210	740	2390
3540	1750	1290	1240	750	2450
3780	1790	1320	1260	770	2510
4050	1830	1350	1290	790	2560

DIMENSION OF STOCKLESS ANCHOR					
NORMAL WEIGHT(kg)	B1	C	B	L2	A
4320	1870	1380	1320	800	2620
4590	1910	1410	1350	820	2670
4890	1950	1440	1380	840	2730
5250	2000	180	1410	860	2800
5610	2040	1510	1440	880	2860
6000	2090	1540	1480	900	2930
6450	2140	1580	1510	920	3000
6900	2190	1620	1550	0.94	3070
7350	2240	1650	1580	960	3140
7800	2280	1680	1610	680	3090
8300	2330	1720	1650	1000	3200
8700	2370	1750	1670	1020	3320
9300	2420	1790	1710	1040	3390
9900	2470	1820	1740	1060	3460
10500	2520	1860	1780	1080	3530
11100	2570	1900	1820	1100	3600
11700	2610	1930	1840	1120	3650
12300	2650	1960	1870	1140	3710
12900	2690	1990	1900	1160	3770
13500	2740	2020	1940	1180	3840
14100	2780	2050	1960	1200	3890
14700	2820	2080	1990	1210	3950
15400	2860	2110	2020	1230	4000
16100	2900	2140	2050	1250	4060
16900	2950	2180	2080	1270	4130
17800	3000	2210	2120	1290	4200
18800	3060	2260	2160	1320	4280
20000	3120	2300	2200	1340	4370
21500	3200	2360	2260	1380	4480
23000	3270	2410	2310	1410	4580
24500	3340	2460	2360	1440	4680
26000	3410	2520	2410	1470	4770
27500	3470	2560	2450	1490	4860
29000	3530	2610	2490	1520	4946

# AC 14 TYPE ANCHOR

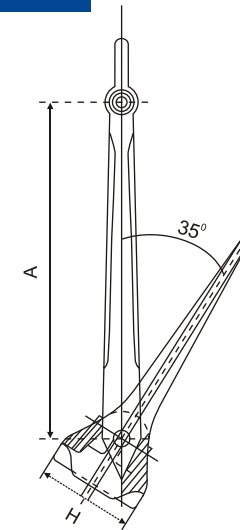
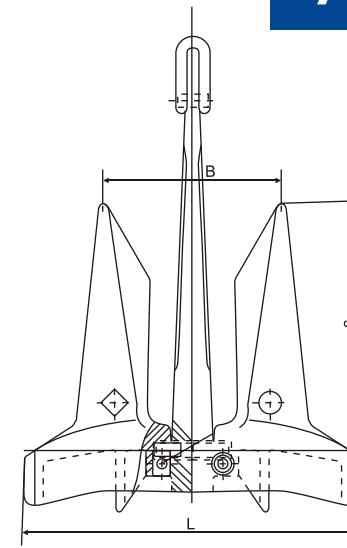

DIMENSION OF AC -14 H.H.P. ANCHOR					
NORMAL WEIGHT(kg)	A	L	H	C	B
180	904	811	251	550	434
225	974	874	270	593	468
340	1109	995	307	675	533
460	1227	1101	340	747	590
675	1398	1254	387	851	672
910	1540	1385	427	938	740
1140	1660	1490	460	1011	798
1360	1761	1580	488	1072	846
1590	1855	1665	514	1130	892
1820	1940	1741	538	1182	933
2040	2016	1809	559	1227	969
2270	2089	1874	579	1272	1004
2720	2218	1991	615	1351	1066
3040	2302	2066	638	1402	1107
3240	2352	2110	652	1432	1130
3445	2400	2154	665	1462	1154
3670	2451	2200	680	1493	1178
3940	2510	2252	696	1529	1207
4210	2566	2303	711	1563	1234
4500	2624	2355	727	1598	1261
4840	2688	2412	745	1637	1292
5175	2749	2467	762	1674	1321
5515	2808	2520	778	1710	1350
5850	2864	2570	794	1744	1376
6225	2923	2623	810	1780	1405

DIMENSION OF AC -14 H.H.P. ANCHOR					
NORMAL WEIGHT(kg)	A	L	H	C	B
6525	2970	2665	823	1808	1428
6600	2981	2675	820	1815	1433
7015	3042	2730	843	1853	1462
7425	3100	2782	859	1888	1490
7875	3162	2837	876	1925	1520
8325	3221	2890	893	1961	1548
8775	3278	2942	909	1996	1576
9225	3333	2991	924	2030	1602
9675	3386	3039	939	2062	1628
10125	3438	3085	953	2094	1653
10575	3438	3130	967	2124	1677
10690	3501	3141	970	2132	1683
11025	3537	3174	981	2154	1700
11250	3561	3196	987	2169	1712
11550	3592	3224	996	2188	1727
11850	3623	3251	1004	2206	1742
12075	3646	3272	1011	2220	1753
12525	3691	3312	1023	2248	1774
12675	3705	3325	1027	2256	1781
13200	3756	3370	1041	2287	1805
13350	3770	3383	1045	2296	1812
13875	3819	3426	1059	2326	1836
14100	3839	3445	1064	2338	1846
15000	3919	3517	108	2387	1884
16125	4015	3603	1113	2445	1930
17250	4106	3685	1138	2501	1974
18375	4194	3763	1163	2554	2016
19500	4278	3839	1186	2605	2056



## DELTA FLIPPER ANCHOR

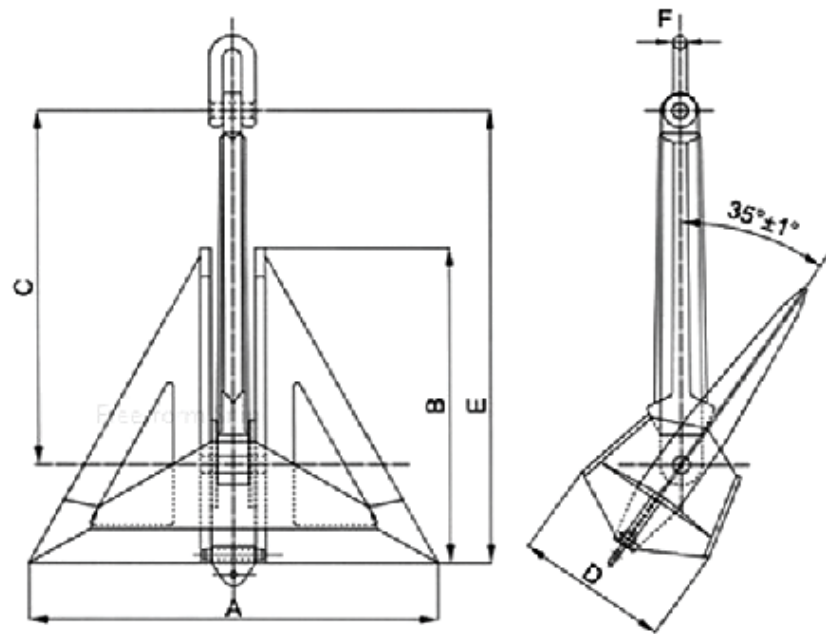

Weight kg	A mm	B mm	C mm	D mm	E mm	F mm
300	1200	960	1080	457	1380	45
500	1500	1200	131	571	1725	50
1000	187.5	1500	1686	714	2155	62
1080	1915	1530	1686	722	2200	62
2000	2363	1890	2124	900	2715	74
3000	2700	2160	2430	1028	3105	90
4000	2975	2380	2676	1133	3420	100
5000	3250	2600	2922	1238	3735	110
7000	3575	2860	3216	1361	4110	117
9000	3950	3160	351	1504	4543	135
10000	4100	3280	3690	1561	4715	140
12000	4490	3575	4030	1695	5320	145
13500	4670	3720	4195	1765	5535	150
15000	4845	3875	4355	1830	5735	150
18000	5140	4080	4610	1940	6080	160
20000	5330	4260	4790	2010	6310	170
22500	5490	4360	4905	2060	6470	180
25000	5740	4590	5160	2165	6795	180

## KENTER SHACKLES

### CHAIN AND FITTINGS

Kenter Shackles are used to join 'common chain links' and have equivalent proof qualities as the same diameter chain size.

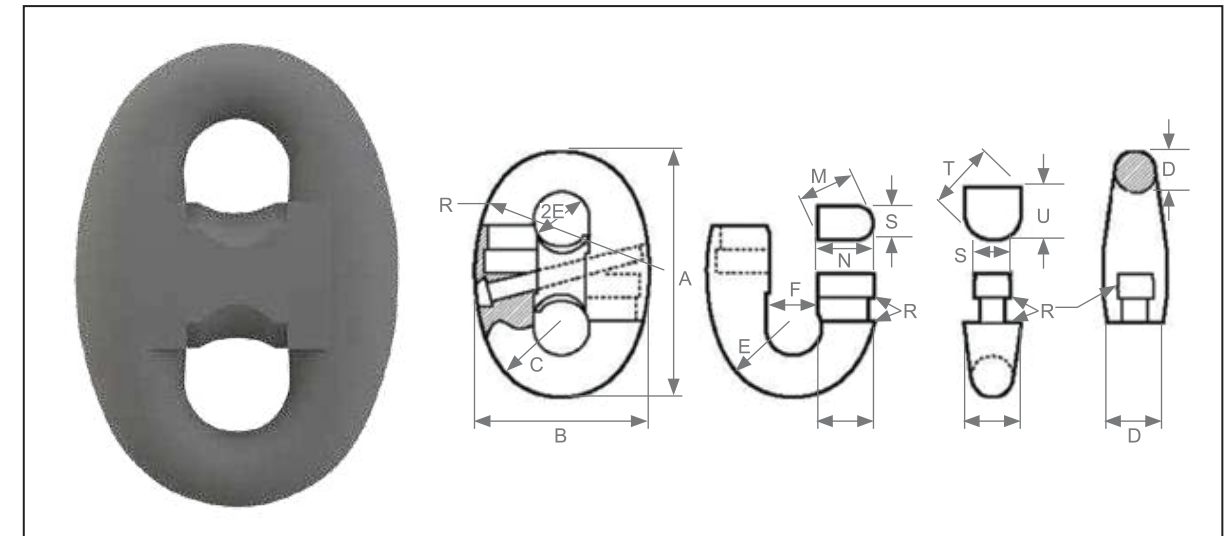

Dimension	Nominal Dimension Times d	Tolerance %	
		+	-
A	6.00	2.0	2.0
B	4.20	2.0	2.0
C	1.83	2.0	2.5
E	0.67	2.5	0.0
R	4.50	2.0	2.5
K	1.40	2.0	2.5
S	1.1	2.5	2.5
M	1.45	2.5	2.5
N	1.32	2.5	2.5
W	1.34	2.5	2.5
F	1.13	2.5	0.0
T	1.59	2.0	2.5
U	1.30	2.0	2.5
D	1.52	2.0	2.5
d	1.00	2.0	0.0
r	0.03	-	-

All dimensions are approximate.  
d = chain diameter

## ANCHOR JOINING SHACKLE

### CHAIN AND FITTINGS

Aeromarine offers both standard Anchor and Chain Joining shackles as well as long term mooring LTM options.

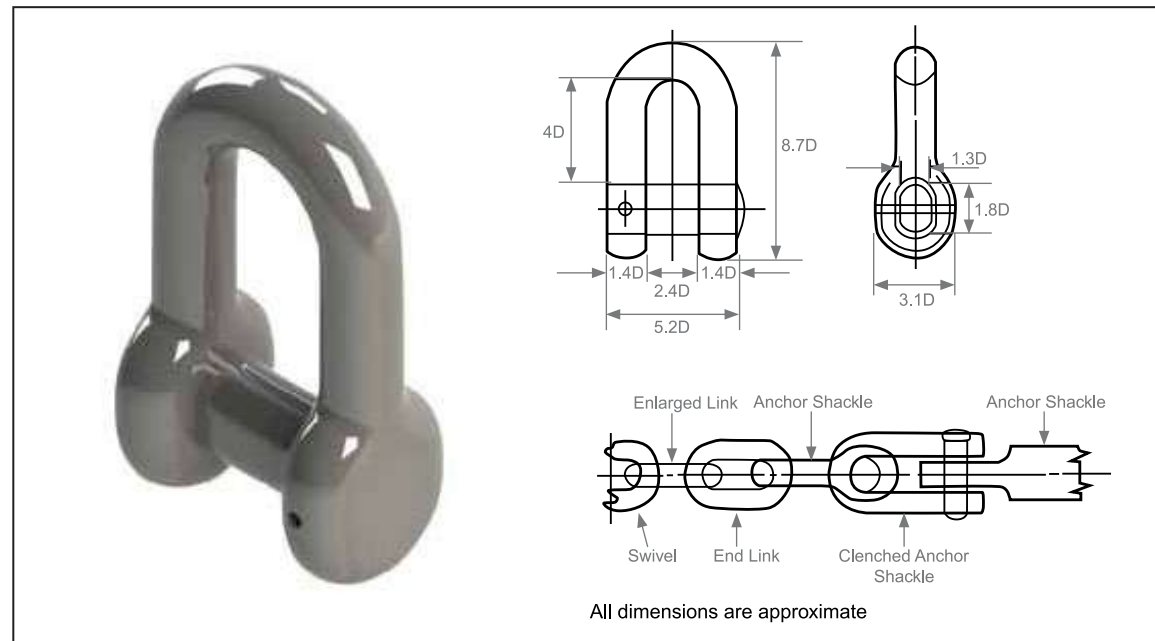

Size (mm)	Weight (kg)
19	1.7
22	2.7
26	4.3
30	7
32	7.8
34	8.5
38	13.8
41	18
44	22
48	27
52	29
54	39
57	46
60	52
64	64
67	74

Size (mm)	Weight (kg)
70	84
73	98
76	110
79	122
83	134
86	144
89	154
92	168
95	184
98	200
102	220
105	230
108	264
110	285
114	320
120	340



Example of AJ 'LTM' Shackle

## SWIVEL FORERUNNER ASSEMBLY

### CHAIN AND FITTINGS

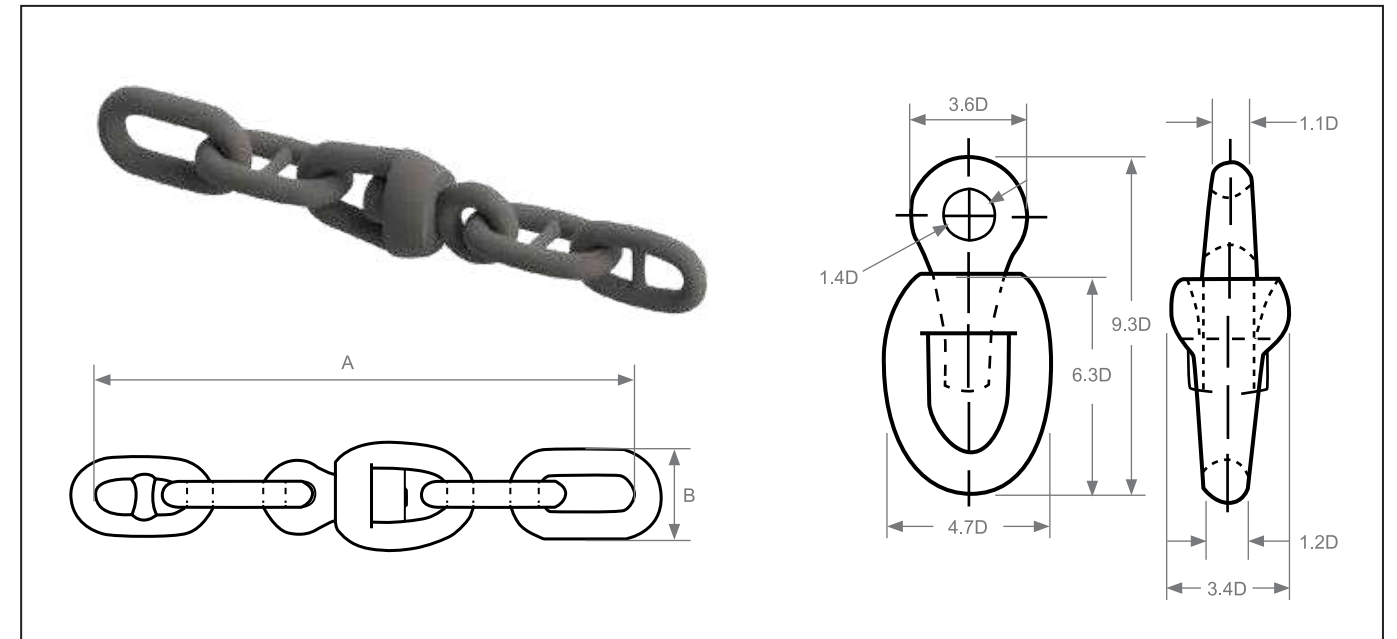

Size (mm)	Inside Length (mm) ['A']	Outside Width (mm) ['B']	Weight (Swivel ONLY) (kg)	Min Break Load Grade 2 (tonne)	Min Break Load Grade 3 (tonne)
12.5	274.6	50	0.9	9.4	13.5
16.0	392.8	64	1.7	15.3	22.0
17.5	418.9	70	2.1	18.3	26.1
19.0	466.5	76	2.8	21.5	30.7
20.5	512.1	82	3.8	24.9	35.6
22.0	540.1	88	4.4	28.6	40.9
24.0	589.2	96	5.2	33.9	48.5
26.0	623.5	104	6.8	39.7	56.7
32.0	785.6	128	12.7	59.4	84.9
34.0	834.7	136	17.5	66.8	95.5
40.0	982.0	160	29	91.4	131.0
50.0	1227.5	200	54	140.0	200.0
64.0	1571.2	256	90	223.0	319.0
76.0	1865.8	304	152	307.0	438.0
84.0	2062.2	336	190	368.0	526.0
94.0	2307.7	376	275	460.0	657.0

All dimensions are approximate.  
Other swivel assembly combinations are available.

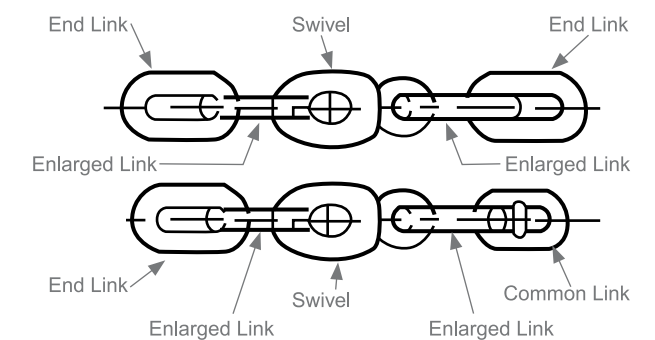

### TYPICAL SWIVEL ASSEMBLIES

# TRI-PLATE

## CHAIN AND FITTINGS

Tri-Plates are widely used for tow and bridle applications in the marine industry. These are standard products or could be produced to meet the defined load criteria. Aeromarine stocks regular towing plates for marine use, but may supply modified Tri-Plates and Bifurcation plates for any purpose, such as mooring, lifting and towing.



Standard Tri-Plate

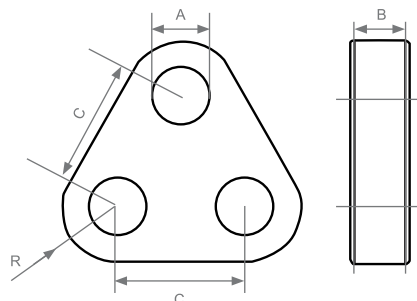

Towing Plate

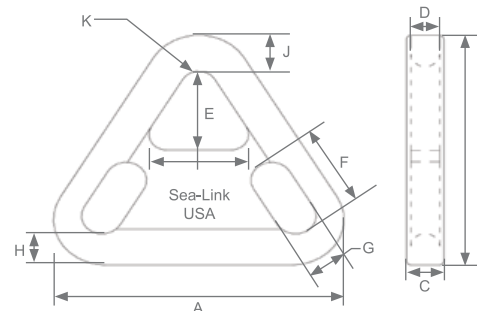

### Standard Tri-Plate

Part No.	WLL (ton)	MBL (ton)	A (mm)	B (mm)	C (mm)	R (mm)	Weight (kg)
75001700	17	85	47	35	120	65	10
75002500	25	125	55	40	150	80	18
75003500	35	175	60	50	160	90	28
75005500	55	275	75	70	210	105	58
75008500	85	425	90	80	230	135	96
75012000	120	600	105	100	280	170	188
75015000	150	750	115	110	320	185	256
75017500	175	875	115	110	320	195	274
75020000	200	1000	140	120	390	215	390
75025000	250	1250	150	140	390	240	518
75030000	300	1500	160	150	420	250	617
75040000	400	2000	185	200	490	300	1170
75050000	500	2500	200	200	550	360	1619
75060000	600	3000	220	200	600	400	1972

Tolerance: Forged parts ±5%, machined parts ±1mm

### Towing Plate

Plate	Shackle Size	A (mm)	B (mm)	C (mm)	D (mm)	E (mm)	F (mm)	G (mm)
NO. 1	1 1/2" to 2"	17 1/2	16	2 1/4	1 3/4	5 1/2	5 3/8	2
NO. 2	2 1/4" to 3"	22 1/2	23	3	2	7	7	3
NO. 3	3 1/2" to 4"	31	31	4	3	10	10	4

Plate	H (mm)	I (mm)	J (mm)	K (mm)	L (mm)	M (mm)	Weight (lbs)	Proof Load (lbs)
NO. 1	2 1/4	6	2 1/2	1	1/4	2 1/4	65	300,000
NO. 2	3 1/4	7	4	1 1/2	3/8	3	165	485,000
NO. 3	4 3/8	10	6	2	3/8	4	550	624,000

Dimensions and heights are subject to change.  
Dimensions are based on inches and pounds.  
All towing plates are supplied with a certificate of conformance and pull test certificates from the factory.

# CHAIN CONFIGURATION OPTIONS

## CHAIN AND FITTINGS

Identifying, ordering and using the right chain in the right configuration can not only make a huge economic difference, but can optimise your tow, bridle, anchoring and mooring system to make it safer and more practical. At Aeromarine, we provide advice on the best chain solution for your applications.



Common Links



Three Link Adaptor



Swivel - (-w-) integrated chain and end link



Common Link

Enlarged Link

End Link



Anchor Pig Tail



Pear Shaped Link for Smit Brackets



Swivel Forerunner Assembly

### Chain Abbreviations

- CL Common Link
- EL Enlarged Link
- E End Link
- KS Kenter Shackles
- AJ Anchor Shackle
- JS Chain Joining Shackle
- SW Swivel Claw
- MC Metres of Chain

