



HYDRAULIC & POWER ASSISTED STEERING FOR OUTBOARDS

POWER ASSISTED STEERING FOR OUTBOARD :



The Standard Power Steering Kit for Single Cylinder - Single Outboard includes:

List of Components	Outboards up to 350 HP	Outboards up to 350 HP	Quantity
Steering Kit	PS350 (Regular Use)	PS350P (Aggressive Use)	1 No.
Cylinder	OC350	OC350P	1 No.
Helm	PH33	PH33	1 No.
Hose Kit	CT-7.5	CT-7.5	2 Nos.
Steering Fluid	HO-150	HO-150	2 Liters
Steering Wheel Revolution	4	4.7	Lock to Lock

The Standard Power Steering Kit for Single Cylinder - Dual Outboards includes:

List of Components	Outboards up to 350 HP	Outboards up to 350 HP	Quantity
Steering Kit	PS350-1CD (Regular Use)	PS350P-1CD (Aggressive Use)	1 No.
Cylinder	OC350	OC350	1 No.
Helm	PH33	PH33	1 No.
Hose Kit	CT-7.5	CT-7.5	2 Nos.
Steering Fluid	HO-150	HO-150	2 Liters
Steering Wheel Revolution	4	4.7	Lock to Lock
Additional Component			
Tie Rod Kit	TRX	TRX	1 No.

The Standard Power Steering Kit for Dual Cylinders - Dual Outboards includes:

List of Components	Outboards up to 350 HP	Outboards up to 350 HP	Quantity
Steering Kit	PS350-2CD (Regular Use)	PS350P-2CD (Aggressive Use)	1 No.
Cylinder	OC350	OC350P	1 No.
Helm	PH33	PH40	1 No.
Hose Kit - 1	CT-7.5	CT-7.5	2 Nos.
Hose Kit - 2	CT-1.0	CT-1.0	2 Nos.
T-Fitting	TF1	TF1	2 Nos.
Steering Fluid	HO-150	HO-150	2 Liters
Steering Wheel Revolution	8	7.7	Lock to Lock
Additional Component			
Tie Rod Kit	TRX	TRX	1 No.

The Standard Power Steering Kit for Dual Cylinders - Triple Outboards includes:

List of Components	Outboards up to 350 HP	Quantity
Steering Kit	PS350P-2CT (Aggressive Use)	1 No.
Cylinder	OC350P	2 No.
Helm	PH40	1 No.
Hose Kit - 1	CT-7.5	2 Nos.
Hose Kit - 2	CT-1.5	2 Nos.
Hose Kit - 3	CT-1.0	2 Nos.
T-Fitting	TF1	2 Nos.
Steering Fluid	HO-150	3 Liters
Steering Wheel Revolution	7.7	Lock to Lock
Additional Component		
Tie Rod Kit	TRX	2 No.

The Standard Power Steering Kit for Dual Cylinders - Quad Outboards includes:

List of Components	Outboards up to 350 HP	Quantity
Steering Kit	PS350P-2CQ (Aggressive Use)	1 No.
Cylinder	OC350P	2 No.
Helm	PH40	1 No.
Hose Kit - 1	CT-7.5	2 Nos.
Hose Kit - 2	CT-2.0	2 Nos.
Hose Kit - 3	CT-1.0	2 Nos.
T-Fitting	TF1	2 Nos.
Steering Fluid	HO-150	3 Liters
Steering Wheel Revolution	7.7	Lock to Lock
Additional Component		
Tie Rod Kit	TRX	3 No.

NOTE : Please refer the Tie Rod Kit guide for assistance in selecting the appropriate Tie Rod.

Components of Power Assisted Steering

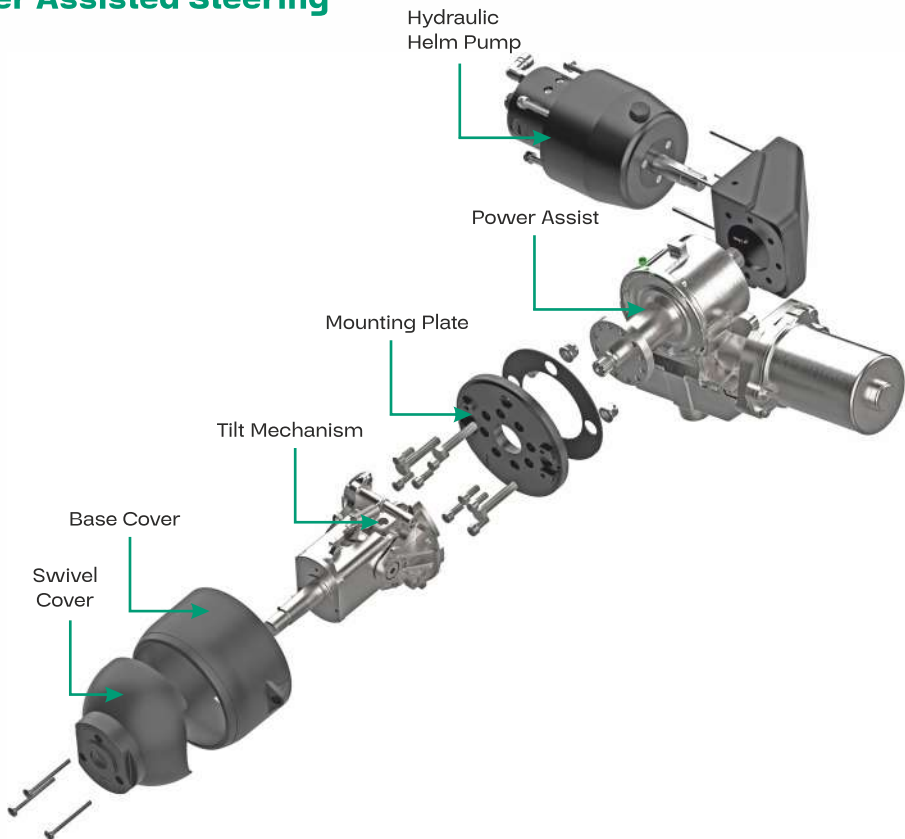

HYDRAULIC STEERING FOR OUTBOARD DIFFERENT TYPES OF STEERING ASSEMBLIES



The Standard Hydraulic Steering Kit for Single Cylinder - Single Outboard includes:

List of Components	Outboards up to 115 HP	Outboards up to 175 HP	Outboards up to 350 HP	Outboards up to 350 HP	Quantity
Steering Kit	K115U	K175	K350 (Regular Use)	K350P (Aggressive Use)	1 No.
Cylinder	OC-115U	OC175	OC350	OC350P	1 No.
Helm	H18M	H18	H25	H25	1 No.
Hose Kit	CT-5.0	CT-7.5	CT-7.5	CT-7.5	2 Nos.
Steering Fluid	HO-150	HO-150	HO-150	HO-150	2 Liters
Steering Wheel Revolution	5	6.8	5.2	6.1	Lock to Lock

The Standard Hydraulic Steering Kit for Single Cylinder - Dual Outboards includes:

List of Components	Outboards up to 350 HP	Outboards up to 350 HP	Quantity
Steering Kit	K350-1CD (Regular Use)	K350P-1CD (Aggressive Use)	1 No.
Cylinder	OC350	OC350P	1 No.
Helm	H25	H25	1 No.
Hose Kit	CT-7.5	CT-7.5	2 Nos.
Steering Fluid	HO-150	HO-150	2 Liters
Steering Wheel Revolution	5.2	6.1	Lock to Lock
Additional Component			
Tie Rod Kit	TRX	TRX	1 No.

The Standard Hydraulic Steering Kit for Dual Cylinders - Dual Outboards includes:

List of Components	Outboards up to 350 HP	Outboards up to 350 HP	Quantity
Steering Kit	K350-2CD (Regular Use)	K350P-2CD (Aggressive Use)	1 No.
Cylinder	OC350	OC350	1 No.
Helm	H33	H33	1 No.
Hose Kit - 1	CT-7.5	CT-7.5	2 Nos.
Hose Kit - 2	CT-1.0	CT-1.0	2 Nos.
T-Fitting	TF1	TF1	2 Nos.
Steering Fluid	HO-150	HO-150	2 Liters
Steering Wheel Revolution	8	9.3	Lock to Lock
Additional Component			
Tie Rod Kit	TRX	TRX	1 No.

The Standard Hydraulic Steering Kit for Dual Cylinders - Triple Outboards includes:

List of Components	Outboards up to 350 HP	Quantity
Steering Kit	K350P-2CT	1 No.
Cylinder	OC350P	2 No.
Helm	H33	1 No.
Hose Kit - 1	CT-7.5	2 Nos.
Hose Kit - 2	CT-1.5	2 Nos.
Hose Kit - 3	CT-1.0	2 Nos.
T-Fitting	TF1	2 Nos.
Steering Fluid	HO-150	3 Liters
Steering Wheel Revolution	9.3	Lock to Lock
Additional Component		
Tie Rod Kit	TRX	2 No.

NOTE : Please refer the Tie Rod Kit guide for assistance in selecting the appropriate Tie Rod.

Technical Specifications for Tie Rod

TR1 / TR2

Part No.	Size (mm)	Port	Description
TR1	660-914	M12X1.25	For Dual Outboards Single Cylinder
TR2	660-914	M14X2	For Dual Outboards Single Cylinder
TR1S	660-914	M12X1.25	For Dual Outboards Single Cylinder
TR2S	660-914	M14X2	For Dual Outboards Single Cylinder

NOTE : Please refer the Fig. B for Tie Rod Arrangement

TR1D / TR2D

Part No.	Size (mm)	Port	Description
TR1D	660-914	M12X1.25	For Dual Outboards Dual Cylinders
TR2D	660-914	M14X2	For Dual Outboards Dual Cylinders

NOTE : Please refer the Fig. C and D for Tie Rod Arrangement

ADJUSTABLE TIE ROD : TRA

Part No.	Size (mm)	Port	Description
TRA3	635-654	1/2" UNEF	For Dual Outboards Single Cylinder
TRA4	655-779	1/2" UNEF	For Dual Outboards Single Cylinder
TRA5	780-999	1/2" UNEF	For Dual Outboards Single Cylinder
TRA6	1000-1384	1/2" UNEF	For Dual Outboards Single Cylinder

NOTE : Please refer the Fig. D for Tie Rod Arrangement

Part No.	Size (mm)	Port	Description
TRAD1	711-739	1/2" UNEF	For Dual Outboards Dual Cylinders
TRAD2	740-779	1/2" UNEF	For Dual Outboards Dual Cylinders
TRAD3	780-849	1/2" UNEF	For Dual Outboards Dual Cylinders
TRAD4	850-976	1/2" UNEF	For Dual Outboards Dual Cylinders
TRAD5	997-1197	1/2" UNEF	For Dual Outboards Dual Cylinders
TRAD6	1198-1580	1/2" UNEF	For Dual Outboards Dual Cylinders

NOTE : Please refer the Fig. D and F for Tie Rod Arrangement

The Standard Hydraulic Steering Kit for Dual Cylinders - Quad Outboards includes:

List of Components	Outboards up to 350 HP	Quantity
Steering Kit	K350P-2CT	1 No.
Cylinder	OC350P	2 No.
Helm	H33	1 No.
Hose Kit - 1	CT-7.5	2 Nos.
Hose Kit - 2	CT-1.5	2 Nos.
Hose Kit - 3	CT-1.0	2 Nos.
T-Fitting	TF1	2 Nos.
Steering Fluid	HO-150	3 Liters
Steering Wheel Revolution	9.3	Lock to Lock
Additional Component		
Tie Rod Kit	TRX	2 No.

CYLINDER INSTALLATION ARRANGEMENT :

Fig. A : Single Cylinder - Single Outboard

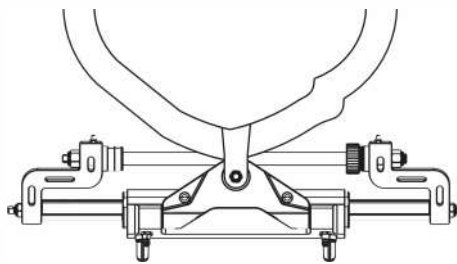

Fig. B : Single Cylinder - Dual Outboards

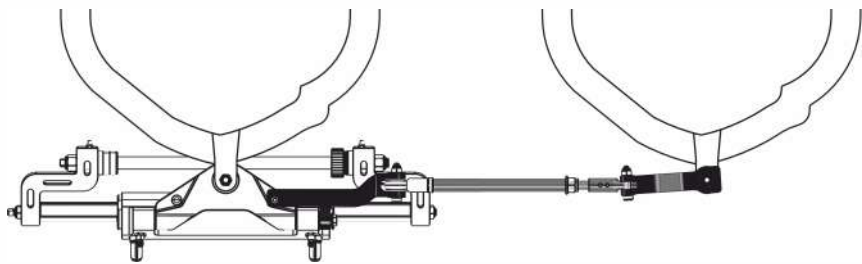

Fig. C : Dual Cylinders - Dual Outboards

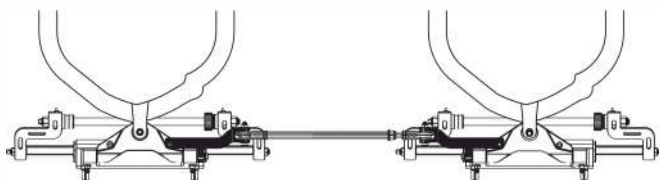

Fig. D : Dual Cylinders - Dual Outboards Heavy Duty Tie Rod

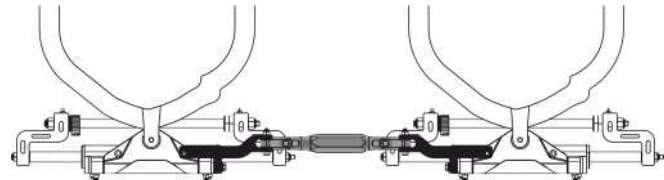

Fig.E : Dual Cylinders - Triple Outboards Heavy Duty Tie Rod

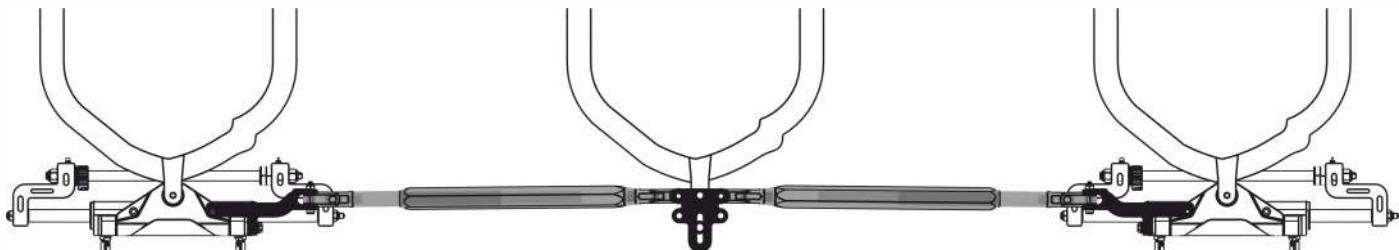
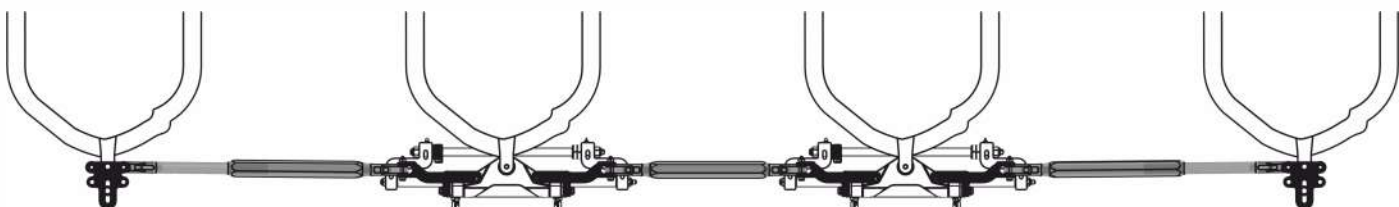

Fig. F : Dual Cylinders - Quad Outboards Heavy Duty Tie Rod



GMG TECHNOTRADES PVT. LTD.

W-82/83/84, MIDC Industrial Area, Hingna Road, Nagpur, Maharashtra (India) -440016

customer care@glydus.com | www.glydus.com